



## *Rollbox* Room Darkening

A premium heavy duty Room Darkening cassette system with optional side channels

TOTAL SOLAR SHADING SOLUTIONS

TURNKEY PROJECTS FOR THE CONTRACT MARKET

COMPLEX PROJECTS MADE EASY

**0207 697 1188**

# Rollbox Room Darkening

A premium heavy duty Room Darkening cassette system with optional side channels



## Features and Options:

- Chain, crank or motorised control options.
- Geared clutch option available for chain control of large drop blinds for easy and smooth operation.
- Motorised options available in radio-controlled or hardwired with wall switch or handset remote control.
- Side channels available in optional widths of 80mm and 120mm.
- Both systems available as “cassettes only” without the need for side channels.
- Bottom channel option available for more effective light exclusion.
- Headbox, bottom bar and side channel powder-coated standard finishes in RAL 9016 white, RAL 9005 black, silver anodised, bronze anodised. Any specific RAL colour is available as an option.
- Telescopic side channels offer 25mm of tolerance allowing more flexibility for irregular and uneven openings or recesses.
- Headboxes are designed with an opening feature allowing easy access for inspection and maintenance.

## Warranty:

10 year warranty against defects in hardware and componentry.



Motor Cassette Detail



Crank Cassette Detail



Chain Cassette Detail

## Technical Specification:

- 1. Headbox** - aluminium alloy 6060 T6 UNI 8278, powder-coated finish, Rollbox 285 dimensions 85mm x 102,2mm, Rollbox 2115 dimensions 115mm x 136,5mm.
- 2. Roller Tube** - 36,47,60mm diameter aluminium alloy UNI 6060.
- 3. Side Channel** - 50-65mm telescopic aluminium alloy UNI 6060, powder-coated finish.
- 4. Bottom Bar** - 33mm x 13mm aluminium alloy UNI 6060, powder-coated finish with black brush.
- 5. Motor** - 40mm and 50mm 240v tubular motor.
- 6. Crank Mechanism** - direct clutch operation, 45° or 90° angled winch operating for crank handle.
- 7. Chain Mechanism** - direct or geared clutch operation with stainless steel bead chain.
- 8. End Plate** - 3mm steel alloy plate with plastic colour co-ordinated endcap.
- 9. Mounting Brackets** - 3mm steel, suitable for ceiling or wall installation, powder-coated finish.

## System Limitations:

### Rollbox 85

- **Maximum Width:**  
4000mm on 150g/m<sup>2</sup>, 3800mm 330g/m<sup>2</sup>, 3400mm 550g/m<sup>2</sup>
- **Maximum Drop:**  
4000mm on 150g/m<sup>2</sup>, 3600mm 330g/m<sup>2</sup>, 2400mm 550g/m<sup>2</sup>
- **Maximum M2:**  
16m<sup>2</sup> with 150g/m<sup>2</sup>, 12m<sup>2</sup> with 330g/m<sup>2</sup>, 5.5m<sup>2</sup> 550g/m<sup>2</sup>

### Rollbox 115

- **Maximum Width:**  
4000mm on 150g/m<sup>2</sup>, 4000mm 330g/m<sup>2</sup>, 3800mm 550g/m<sup>2</sup>
- **Maximum Drop:**  
4000mm on 150g/m<sup>2</sup>, 4000mm 330g/m<sup>2</sup>, 3600mm 550g/m<sup>2</sup>
- **Maximum M2:**  
16m<sup>2</sup> with 150g/m<sup>2</sup>, 16m<sup>2</sup> with 330g/m<sup>2</sup>, 12m<sup>2</sup> 550g/m<sup>2</sup>

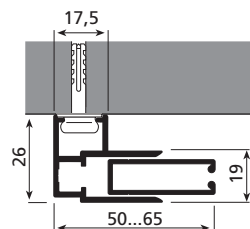

Face Fix Side Channel

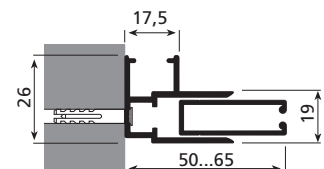

Side Fix Side Channel

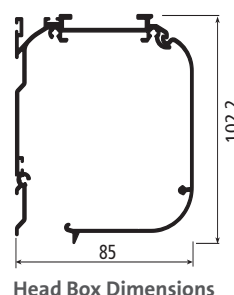

Head Box Dimensions

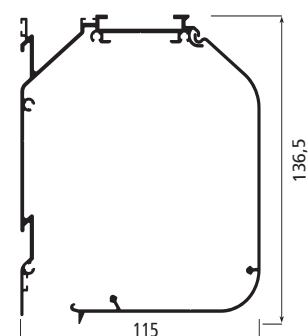

# Rollbox Room Darkening

## Blind Components and Dimensions

### Motorised Option

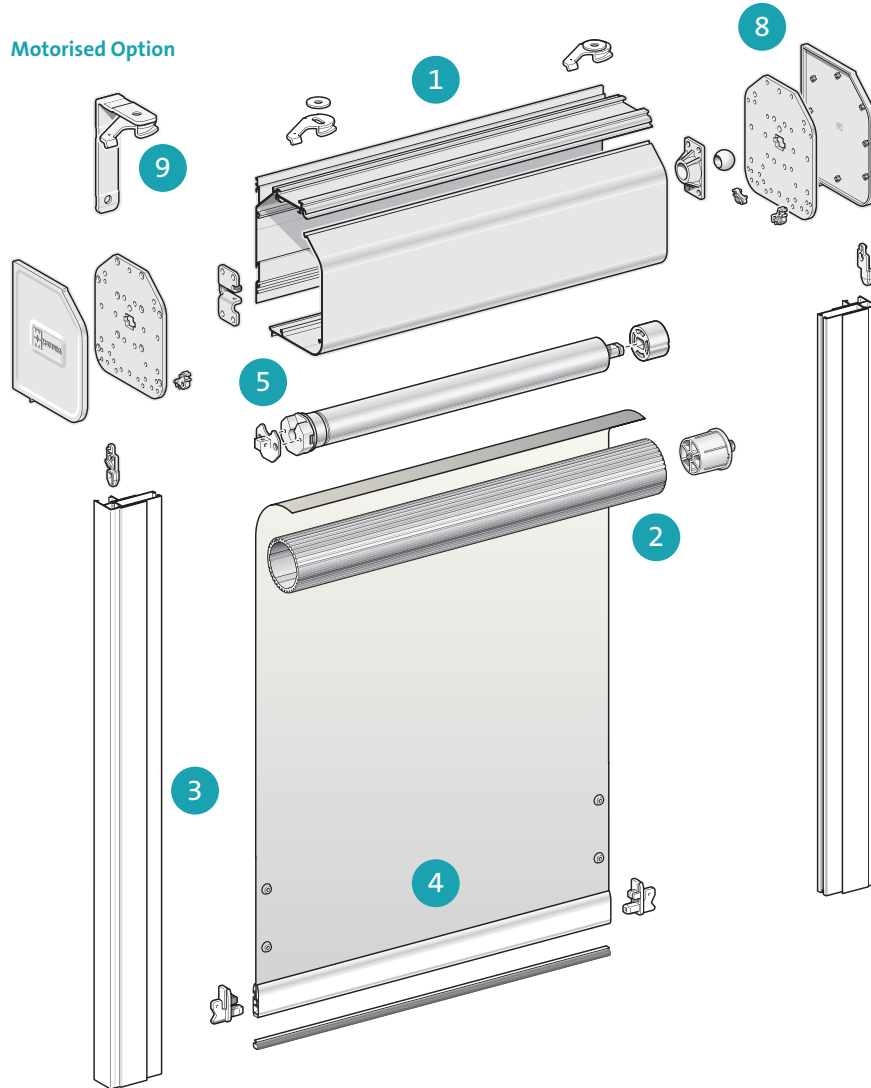

### Crank Option

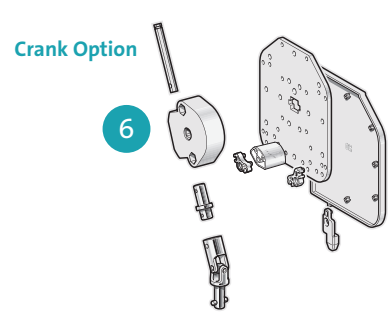

### Chain Option

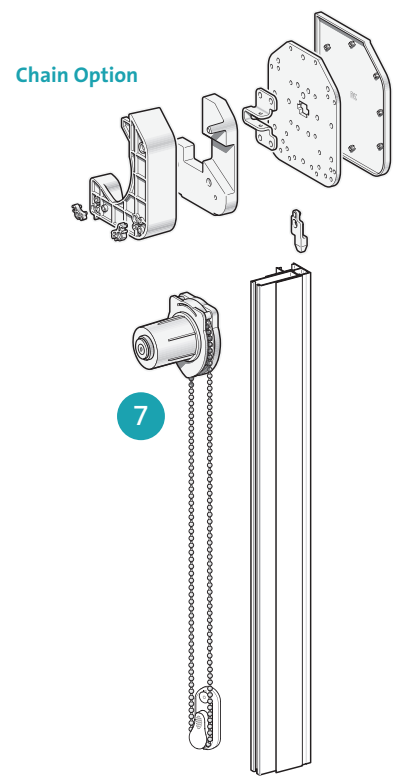





## About BAB Projects:

Our product collection offers a diverse and specialist range of shading systems. Internal or external window coverings are manufactured and installed to withstand the rigours of daily usage whilst still providing an unrivalled blend of style and comfort all over the UK.

### **BAB PROJECTS - SPECIALIST SPECIFICATION DIVISION:**

is staffed by experts in shading and auto control systems. Products are tailored to commercial buildings solely for architects and the construction community.

*At your service, our team comprises:*

- Quantity Surveyor
- Specification Sales Support
- Indoor Account Management
- Project Managers
- Logistic Team
- Specialist Installers

Our own high performance commercial manual and motorised blind systems are conveniently manufactured near the new St Pancras International Station Central London.

Key partners include Warema, Silent Gliss, Shy Systems, Guthrie Douglas, Somfy, Q Motion, Lutron, Mottura, MechoSystems and Draper Inc.

**HISTORY** - BAB Projects is a division of Bright A Blind (services) which has been established in London since 1990 and has steadily spread throughout the South East and most of the UK, serving many of the biggest and most prestigious companies in the country. We work throughout the UK installing, maintaining, cleaning, replacing and repairing blinds of all types.

## Knowledge | Passion | Experience

BAB PROJECTS

1-3 North Road London N7 9HA

Email: [info@babprojects.com](mailto:info@babprojects.com)

*BAB Projects is the specialist specification division of Bright A Blind*

**BRIGHT A BLIND**   
CLEANING • MAINTENANCE • REPAIRS • REPLACEMENTS

0207 697 1188

[www.babprojects.com](http://www.babprojects.com)